



Type JP175 Suspended Pipe Anchor

Specification

Electro-galvanized carbon steel pipe anchor consisting of a 2 part fixed point clamp complete with 2 x angular braces and fixing kit. Plastic coated Carbon Steel and Stainless Steel anchor clamps are available for use with Copper and Stainless Steel Pipework

Application

Stourflex pipe anchors are designed to provide the fixing points necessary when expansion joints are to be installed. The pipe anchor is a readily available alternative to fabricating and welding on site. The anchor can be supplied fully assembled or in kit form. The pipe anchor is suitable for floor, ceiling and wall mounted pipework installations. The JP175 pipe anchor is rated for loads up to 2kN and outside diameters up to 67mm.

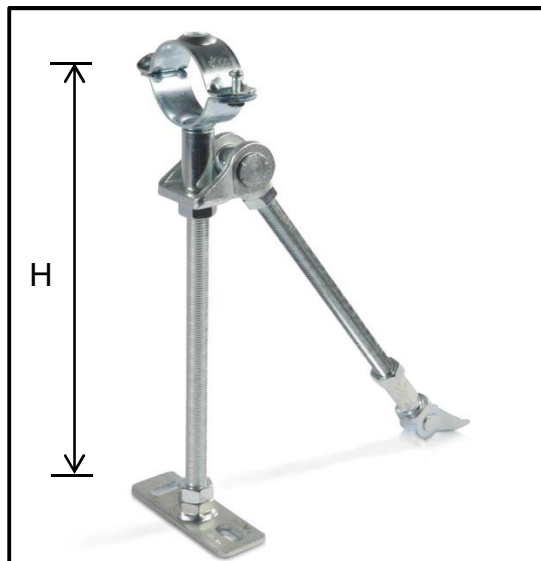

JP175



Part Number For Steel Pipe	Part Number For Copper, Stainless Steel & Pushfit Pipe	Load Rating (kN)	Max Centreline "H" (MM)
JP175-15	JP175-15C	2	350
JP175-20	JP175-22C	2	350
JP175-25	JP175-28C	2	350
JP175-32	JP175-35C	2	350
JP175-40	JP175-42C	2	350
JP175-50	JP175-54C	2	350

JP175-500

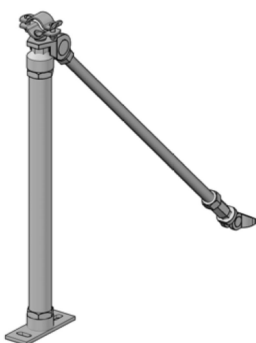

Part Number For Steel Pipe	Part Number For Copper, Stainless Steel & Pushfit Pipe	Load Rating (kN)	Max Centreline "H" (MM)
JP175-500-15	JP175-500-15C	3	500
JP175-500-20	JP175-500-22C	3	500
JP175-500-25	JP175-500-28C	3	500
JP175-500-32	JP175-500-35C	3	500
JP175-500-40	JP175-500-42C	3	500
JP175-500-50	JP175-500-54C	3	500
JP175-500-65	JP175-500-67C	3	500

JP175-500C

(Supplied With Load Distribution Cone & Therefore Must Be Fixed Directly To The Slab)

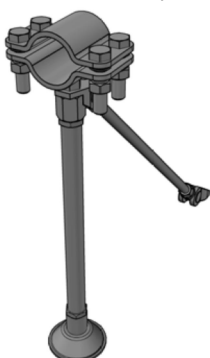

Part Number For Steel Pipe	Load Rating On Steel Pipe. (kN)	Part Number For Copper, Stainless Steel & Pushfit Pipe	Load Rating (kN)	Max Centreline "H" (MM)
JP175-500C-15	9	JP175-500C-15C*	4.5	500
JP175-500C-20	9	JP175-500C-22C	4.5	500
JP175-500C-25	9	JP175-500C-28C	4.5	500
JP175-500C-32	9	JP175-500C-35C	9	500
JP175-500C-40	9	JP175-500C-42C	9	500
JP175-500C-50	9	JP175-500C-54C	9	500
JP175-500C-65	9	JP175-500C-67C	9	500
JP175-500C-80	9	JP175-500C-76C	9	500

*JP175-500C-15C 15mm Copper Size only can be a long lead time item.



STOURFLEX

Technically Advanced Flexible Solutions

J&P Supplies Ltd
Junction Road, Audnam,
Stourbridge, West Midlands,
DY8 4YH
Tel: 01384 393329
Fax: 01384 440212
www.stourflex.co.uk

Installation

Detailed fitting instructions are supplied with each variant of JP175.

Typical Installation Example

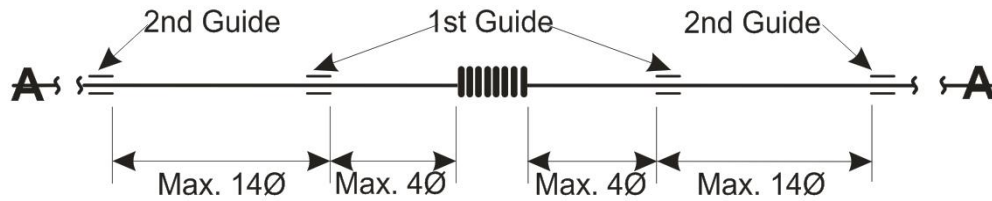

Typical pipework example showing installation where a Stourflex Axial Expansion joint is installed with **JP150** Expansion Joint guides and **JP175** Suspended Pipe Anchors.

Complete range of fixed point clamps available for ABS, PVC, CPVC, Copper, Stainless Steel and Carbon Steel pipework.

Type JP175 Suspended Pipe Anchor can be installed with sound absorbers when it is necessary to ensure that noise or vibration is not transmitted through the buildings structure.

Pipework containing expansion joints must be securely anchored and adequately guided to ensure the correct performance of the system. Omitting anchors and guides may result in failure of the system.

Where anchor loads exceed specified load ratings or pipe diameters are above maximum sizes for this product range please refer to the type JP170 & JP172 suspended pipe anchor.

Stourflex suspended pipe anchors should be installed in accordance with our fitting instructions a copy of which is supplied with each anchor.